

BLACKBERRY

Z10

SMARTPHONE

Start Here



WELCOME TO YOUR NEW BLACKBERRY!

Built to keep you moving.

Screen lock
Power On/Off
(Press and hold)

Headset jack

HDMI display port

USB/charging port
(Connect with facing up)

Front camera

Notification LED

Volume up

Mute
(Press and hold for
Voice Control)

Volume down

Microphone
(Do not cover)

Speaker

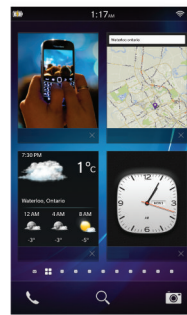

Active Frames



Swipe right for messages



Swipe left for all apps

The home screen keeps you close to the action. You can see your running apps arranged as Active Frames on the home screen. Tap an Active Frame to return the app to full screen. Swipe right to peek into the BlackBerry Hub to flow in and out of your messages and conversations. Swipe left to access all your apps.

1. Insert your SIM card, battery, and optional media card

To remove the battery door, pull up the bottom of the door. The door is flexible and may bend when you remove it. Insert the SIM card first. Next, align the battery contacts to insert the battery. To remove the battery, pull up the colored end of the battery.



2. Set up your smartphone

After the battery is inserted, the Setup app opens. The Setup app needs a network connection, so make sure your smartphone is connected to a mobile network or within range of a Wi-Fi network.

The Setup app prompts you to enter an existing BlackBerry ID or create a new one.

After the initial setup, tap **Setup** on the home screen. You can transfer info from your old device, set up your email, instant messaging, and social networking accounts, and learn more about BlackBerry 10 OS.

3. Transfer information to your smartphone

You can transfer your contacts, pictures, and other info to your new BlackBerry smartphone from your old device. You might be able to back up your information on a media card, or use BlackBerry Link on your computer. You can download BlackBerry Link from www.blackberry.com/startlink.

1. On the home screen, tap **Setup** > **Device Switch**.
2. Complete the instructions on screen.

For step-by-step instructions, visit www.blackberry.com/startswitch.



BBM

Share and be seen with BBM Video. Switch from a BBM chat to a BBM Video conversation with Screen Share to catch up face-to-face and share what is on your screen.*

*Wi-Fi, 4G, or HSPA+ connection required.



BlackBerry Browser

The new BlackBerry Browser. Powerful, responsive, and super-fast.



Time Shift mode

Pinpoint and adjust exact moments of your picture to create the perfect shot. Use BlackBerry Story Maker to merge these moments and create a movie.



BlackBerry World

Discovering and sharing your favorite apps, music, and videos is easier than ever.

To view the Declaration of Conformity made under Directive 1999/5/EC (HG nr. 88/2003), go to www.blackberry.com/go/declarationofconformity. Only use RIM-approved BlackBerry® accessories. This documentation is provided "as is" and without condition, endorsement, guarantee, representation or warranty, or liability of any kind by Research In Motion Limited and its allied companies, all of which are expressly disclaimed to the maximum extent permitted by applicable law in your jurisdiction.

©2012 Research In Motion Limited. All rights reserved. BlackBerry®, RIM®, Research In Motion® and related trademarks, names and logos are the property of Research In Motion Limited and are registered and/or used in the U.S. and countries around the world. Bluetooth is a trademark of Bluetooth SIG. HDMI is a trademark of HDMI Licensing, LLC. Wi-Fi is a trademark of the Wi-Fi Alliance. All other trademarks are the property of their respective owners.
MAT-51795-001 PRINTSPEC-125 SWD-20121112100937353 |
STL100-2(RFH121LW) STL100-3(RFK121LW/RF91LW) STL100-4(RFA91LW)

Return to the home screen and close an app

To exit an app, swipe up from the bottom of the screen to the middle of the screen and release your finger. The app is minimized and appears as a large icon on the home screen as one of your Active Frames. Tap **X** to close the app. To return to the home screen from the BlackBerry Hub after you read your messages, swipe up from the bottom of the screen. The BlackBerry Hub remains open. Simply swipe to the right to see your messages.



Wake up your smartphone

Swipe up from below the screen and release your finger half-way up. For extra security, you can set a password that you enter when you wake up your BlackBerry smartphone. From the home screen, swipe down from the top of the screen and tap **Settings > Security and Privacy > Device Password**. To put your smartphone to sleep, press the Screen Lock button on the top of your smartphone.



Check notifications and read messages

On the home screen or in an app, slide your finger up from the bottom of the screen and pause. Your notifications appear on the left. To peek into the BlackBerry Hub to read messages, slide your finger to the right. To stay in your app, slide your finger to the bottom of the screen.

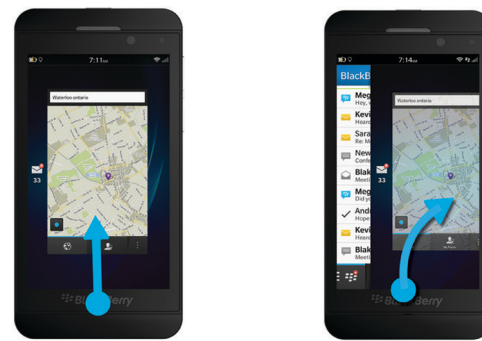

Need more help?

Check the Help app, where you can learn tips, tricks, and strategies for getting the most out of your BlackBerry smartphone. Visit these websites for even more support:

Quick start information: www.blackberry.com/startbb10

Videos: www.blackberry.com/startvideos

Complete user guide: www.blackberry.com/startdocs

Typing tips

The BlackBerry Keyboard helps you spend less time typing and more time communicating. Your BlackBerry smartphone analyzes your writing style and suggests words that you might want to type next. Dictation is also available if your hands are full!

To show the keyboard, tap a text field. To hide it, using two fingers, swipe down on the keyboard, or press and hold the space key.

To use a suggested word, place your finger just below the word and flick it up onto the screen.

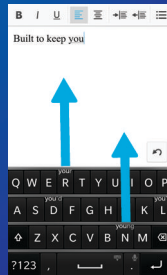
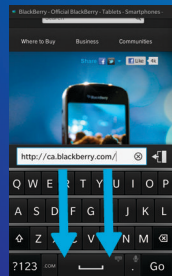

To turn on dictation, on the BlackBerry Keyboard, press and hold .

Find more views and actions in an app

In an app, tap the icon in the lower-left corner of the screen to see what views are available in an app (for example, accounts, folders, message types, and more).

Tap , or tap and hold an item to see what other actions are available.

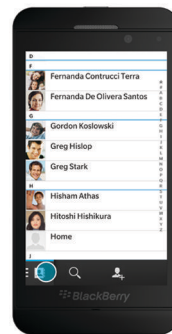

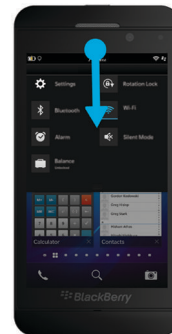

Change settings

On the home screen, or in some apps, swipe down from the top of the screen. Tap  **Settings**.



Find information with Search

Search allows you to search your BlackBerry smartphone for files, messages, contacts, settings, help, and more from one location. You can even extend your search to include Internet sources. Want to learn more about BlackBerry Remember or the Time Shift mode? Search can help you.

1. On the home screen, tap .
2. Tap  to focus your search to a particular area.
3. Type your search term.

Safety information

IT IS IMPORTANT THAT YOU READ THE SAFETY AND PRODUCT INFORMATION BOOKLET (INCLUDED) PRIOR TO USING YOUR BLACKBERRY SMARTPHONE. It contains essential safety information related to your smartphone.

Protecting your smartphone

Now that your BlackBerry smartphone is set up, you can protect it with a range of cases, carrying solutions, and skins. Visit your local retailer for authentic BlackBerry accessories, or shop online at www.blackberry.com/startaccessories.